

CONTENTS:

Drawing Number
PLA230-L01 Context, Contents and Plant Schedule
PLA230-L02 Street Tree Plan 01
PLA230-L03 Street Tree Plan 02

TP1	Town Planning Approval	AD	01.11.18
P3	Amendments to civil & services plans	AD	11.09.18
P2	Power design review	AD	22.03.18
P1	Preliminary Issue	AD	18.03.18
Revision	Description	Initials	Date

APPROVAL ISSUE

Notes

PLANNING PERMIT NUMBER. PLP/2016/141

1. All dimensions to be checked on site before commencing work. All measurements are in metres, unless otherwise shown.
2. The locations of underground services and light poles are indicative only - refer to engineering drawings for design service offsets.
3. The location and depth of services shall be verified on site prior to the commencement of works. The Contractor shall be liable for any damage to services during the landscape works.

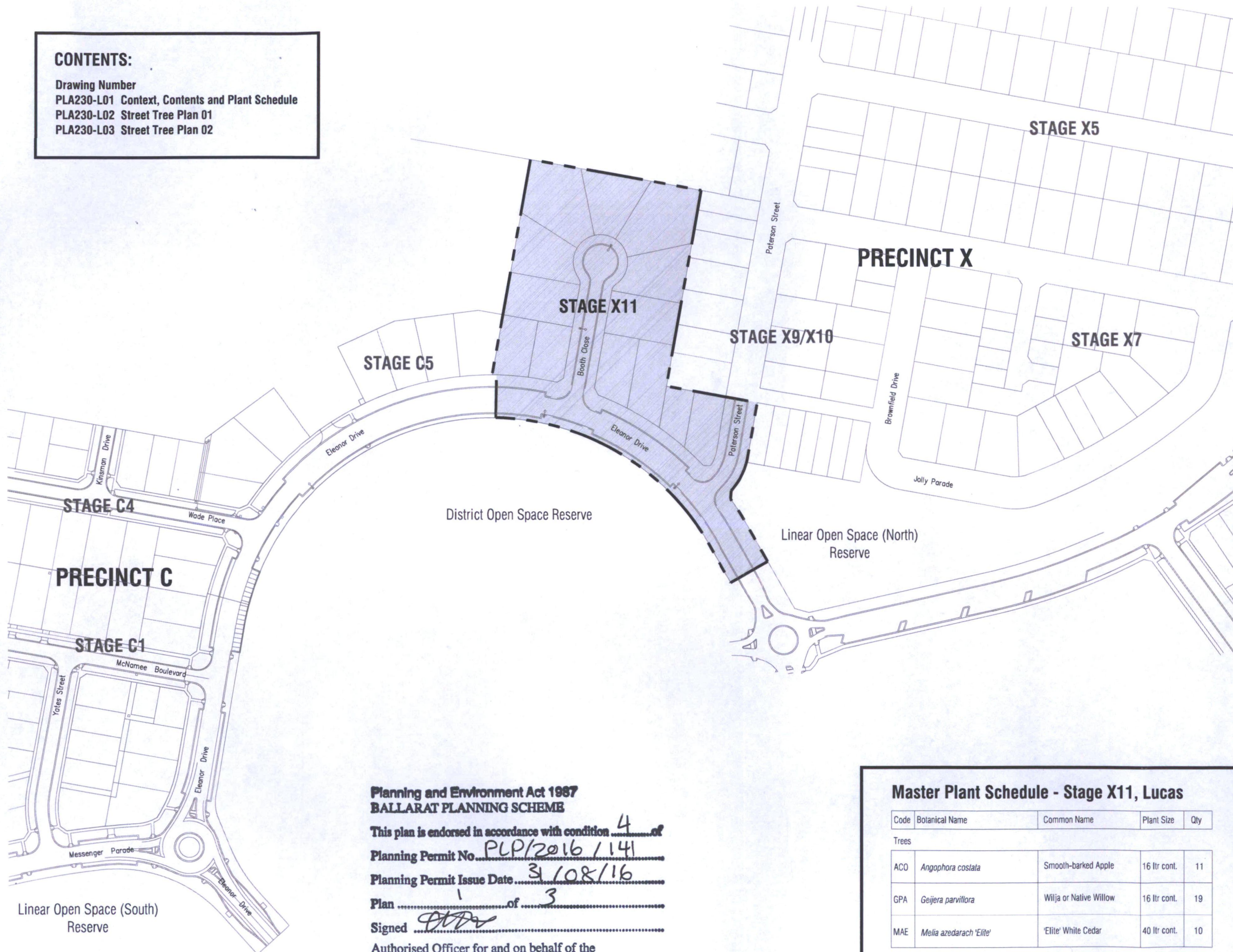

Planning and Environment Act 1987 BALLARAT PLANNING SCHEME

This plan is endorsed in accordance with condition 4 of

Planning Permit No. PLP/2016/141

Planning Permit Issue Date 3/08/16

Plan 1 of 3

Signed [Signature]

Authorised Officer for and on behalf of the
 CITY OF BALLARAT

Date 4/12/18

STAGE x11

Master Plant Schedule - Stage X11, Lucas

Code	Botanical Name	Common Name	Plant Size	Qty
Trees				
ACO	<i>Angophora costata</i>	Smooth-barked Apple	16 ltr cont.	11
GPA	<i>Geijera parvillora</i>	Willja or Native Willow	16 ltr cont.	19
MAE	<i>Melia azedarach</i> 'Elite'	'Elite' White Cedar	40 ltr cont.	10



Client / Project



Stage X11
 Lucas, Ballarat

Drawing Title

Context, Contents and Plant Schedule

Drawn	Approved	Date	North
AD	RH	01.11.18	
Scale (A1)	Scale (A3)	Sheet	
NTS	NTS	1 of 3	

This drawing and design is protected by copyright © PLOT Landscape Architects Pty Ltd.

Drawing Number

PLA230-L01

TP1

Planning and Environment Act 1987
BALLARAT PLANNING SCHEME

This plan is endorsed in accordance with condition 4 of

Planning Permit No. PLP/2016/141

Planning Permit Issue Date 31/8/16

Plan 2 of 3

Signed [Signature]

Authorised Officer for and on behalf of the
CITY OF BALLARAT

Date 4/12/18

STAGE X 11

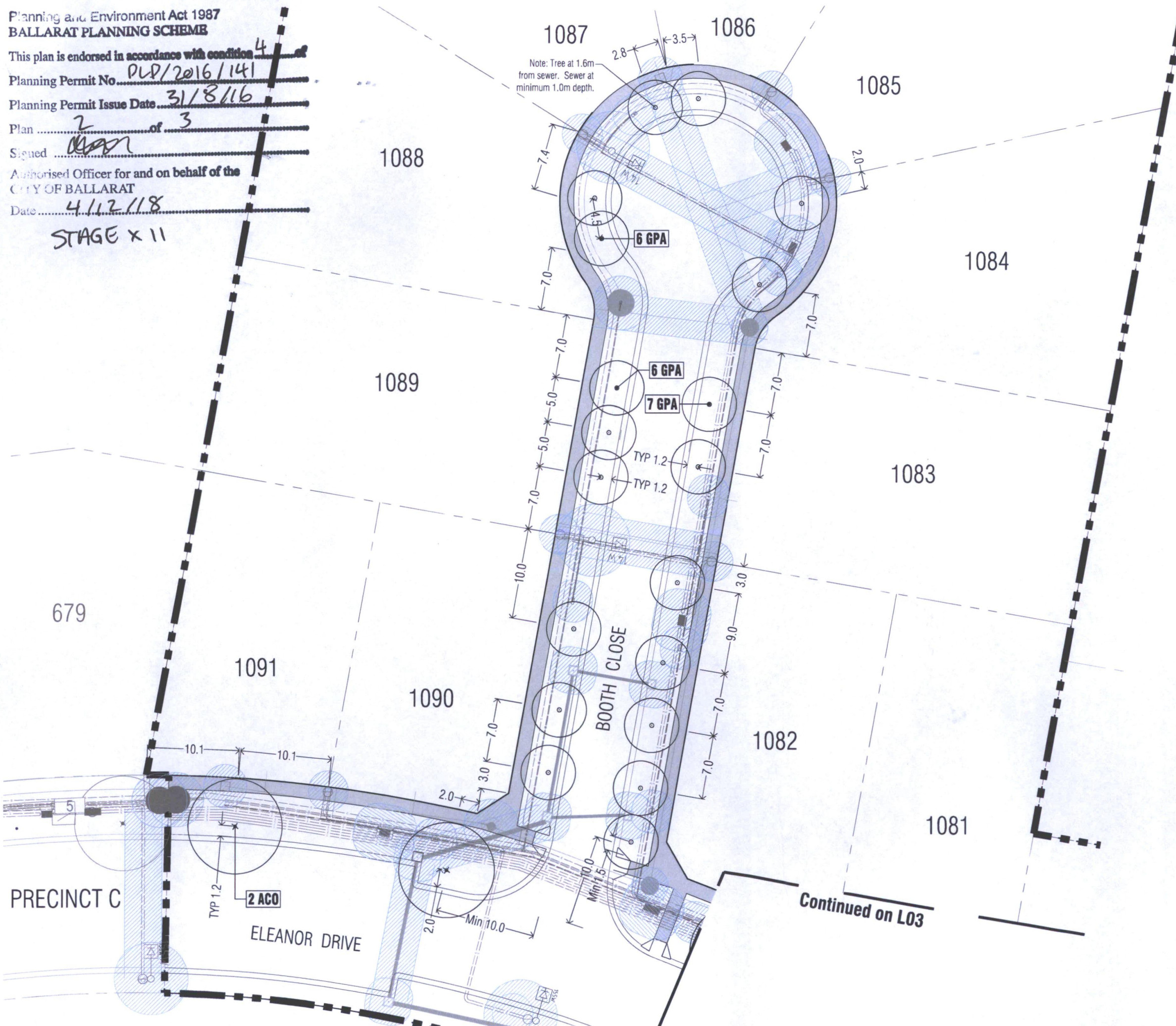

TP1	Town Planning Approval	AD	01.11.18
P3	Amendments to civil and services plan	AD	11.09.18
P2	Power design review	AD	22.03.18
P1	Preliminary Issue	AD	18.03.18
Revision	Description	Initials	Date

APPROVAL ISSUE

Notes

PLANNING PERMIT NUMBER: PLP/2016/141

- All dimensions to be checked on site before commencing work. All measurements are in metres, unless otherwise shown.
- The locations of underground services and light poles are indicative only - refer to engineering drawings for design service offsets.
- The location and depth of services shall be verified on site prior to the commencement of works. The Contractor shall be liable for any damage to services during the landscape works.
- Standard Street Tree Offsets.
 - Standard offset from the back of kerb is 1.2m unless otherwise shown.
 - It is assumed that all Underground Cable in close proximity to the 'tree zone' (5m diameter x 600mm depth) shall be within conduits or have cover slabs to provide a higher level of infrastructure protection. (*Refer 12.0 'Distribution Construction Standard Underground Trenching GA211' by Citypower and Powercor).
 - Minimum setback of 2.5m to underground electricity cable joints / tees.
 - Minimum setback of 2.0m to service assets including pits and conduit crossings.
 - Minimum setback of 0.75m to domestic service tapping points and 2.0m to stormwater outlets.
 - Minimum setback of 1.2m to footpath crossings and 3.0m to driveways where they are existing or known.
 - Minimum setback of 3.0m to fire hydrants.
 - Minimum setback of 4.0m to light poles.
- Proposed Street Trees.
 - Tree position in front of lots may change slightly due to 'actual' location of services, and constructed driveway crossings.
 - Setback from intersection (kerb) shall be a minimum of 10m in accordance with City of Ballarat Landscape Design Manual (LDM).
 - Following City of Ballarat approval of these landscape plans any variation to the number or species of street trees requires approval by City of Ballarat.
- Planting. All trees, shrubs and groundcovers shall be planted in accordance with LDM, unless otherwise specified.
- Mulch. Mulch shall be recycled hardwood (or similar approved) in general accordance with LDM, unless otherwise specified.
- Grass Seeding. Reseed nature strips and other grassed areas where there has been disturbance due to landscape works with a proprietary grass seed mix in accordance with the LDM.
- Refer to drawing PLA230-L01 for Plant Schedule.

Legend

- Existing tree planted as part of a previous stage.
- Proposed Street Trees - *Angophora costata* (Smooth-barked Apple) [ACO]
- Proposed Street Trees - *Geliera parviflora* (Willow / Native Willow) [GPA]
- Service offsets
- Plant Label and Code



Client / Project

Integra
Stage X11
Lucas, Ballarat

Drawing Title

Street Tree Plan 01

Drawn	Approved	Date	North
AD	RH	01.11.18	
Scale (A1)	Scale (A3)	Sheet	
1:200	1:400	2 of 3	

This drawing and design is protected by copyright © PLOT Landscape Architects Pty Ltd.

Drawing Number

PLA230-L02

TP1

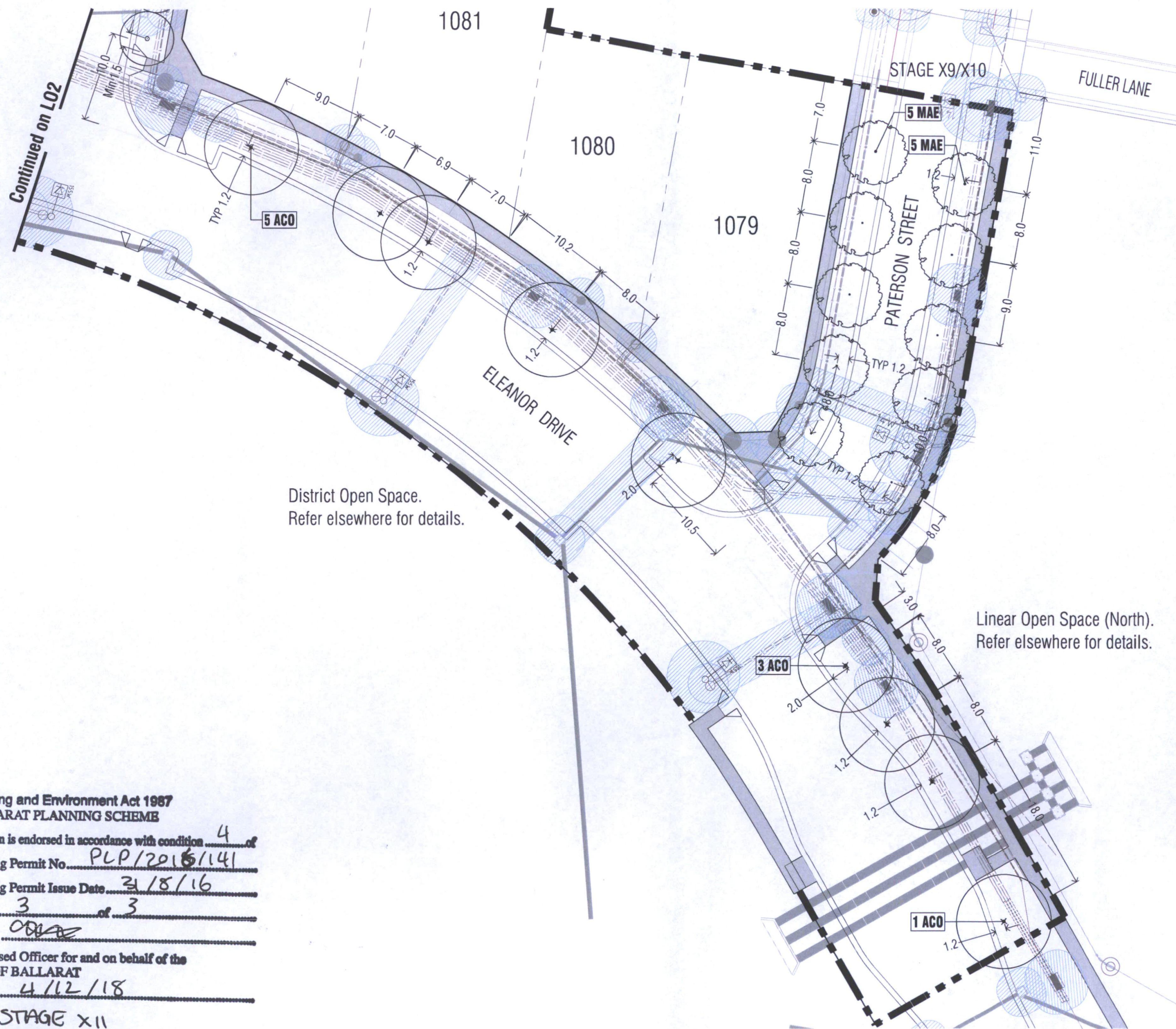

District Open Space.
Refer elsewhere for details.

Linear Open Space (North).
Refer elsewhere for details.

Planning and Environment Act 1987
BALLARAT PLANNING SCHEME

This plan is endorsed in accordance with condition 4 of
Planning Permit No. PLP/2016/141
Planning Permit Issue Date 21/8/16
Plan 3 of 3
Signed [Signature]
Authorised Officer for and on behalf of the
CITY OF BALLARAT
Date 4/12/18

STAGE X11

TP1	Town Planning Approval	AD	01.11.18
P3	Amendments to civil and services plan	AD	11.09.18
P2	Power design review	AD	22.03.18
P1	Preliminary Issue	AD	18.03.18
Revision	Description	Initials	Date

APPROVAL ISSUE

Notes
PLANNING PERMIT NUMBER. PLP/2016/141

- All dimensions to be checked on site before commencing work. All measurements are in metres, unless otherwise shown.
- The locations of underground services and light poles are indicative only - refer to engineering drawings for design service offsets.
- The location and depth of services shall be verified on site prior to the commencement of works. The Contractor shall be liable for any damage to services during the landscape works.
- Standard Street Tree Offsets.
 - Standard offset from the back of kerb is 1.2m unless otherwise shown.
 - It is assumed that all Underground Cable in close proximity to the 'tree zone' (5m diameter x 600mm depth) shall be within conduits or have cover slabs to provide a higher level of infrastructure protection. (Refer 12.0 'Distribution Construction Standard Underground Trenching GA211' by Citypower and Powercor).
 - Minimum setback of 2.5m to underground electricity cable joints / tees.
 - Minimum setback of 2.0m to service assets including pits and conduit crossings.
 - Minimum setback of 0.75m to domestic service tapping points and 2.0m to stormwater outlets.
 - Minimum setback of 1.2m to footpath crossings and 3.0m to driveways where they are existing or known.
 - Minimum setback of 3.0m to fire hydrants.
 - Minimum setback of 4.0m to light poles.
- Proposed Street Trees.
 - Tree position in front of lots may change slightly due to 'actual' location of services, and constructed driveway crossings.
 - Setback from intersection (kerb) shall be a minimum of 10m in accordance with City of Ballarat Landscape Design Manual (LDM).
 - Following City of Ballarat approval of these landscape plans any variation to the number or species of street trees requires approval by City of Ballarat.
- Planting. All trees, shrubs and groundcovers shall be planted in accordance with LDM, unless otherwise specified.
- Mulch. Mulch shall be recycled hardwood (or similar approved) in general accordance with LDM, unless otherwise specified.
- Grass Seeding. Reseed nature strips and other grassed areas where there has been disturbance due to landscape works with a proprietary grass seed mix in accordance with the LDM.
10. Refer to drawing PLA230-L01 for Plant Schedule.

	Proposed Street Trees - Angophora costata (Smooth-barked Apple) [ACO]
	Proposed Street Trees - Melia azedarach 'Elite' (Elite White Cedar) [MAE]
	Service offsets
	Plant Label and Code



Client / Project: **Integra**
Stage X11
Lucas, Ballarat

Drawing Title: **Street Tree Plan 02**

Drawn: AD	Approved: RH	Date: 01.11.18	North
Scale (A1): 1:200	Scale (A3): 1:400	Sheet: 3 of 3	

This drawing and design is protected by copyright © PLOT Landscape Architects Pty Ltd.

Drawing Number: **PLA230-L03** Revision: **TP1**

Chloe Moorcroft

From: David Grant
Sent: 20 November 2018 9:54 AM
To: Chloe Moorcroft
Subject: FW: Landscape Plan for Approval - Stage X11, Lucas (PLP/2016/141)
Attachments: PLA230-L01-L03_TP1-Stage X11 Lucas.pdf; LUC-X11-LDM-schedules.docx; PLP2016141 Precinct X Endorsed Landscape Masterplan.pdf; 180516 Precinct X Development Plan version 11-UNAPPROVED.pdf

Follow Up Flag: Follow up
Flag Status: Flagged

Hi again.

I am also happy to have the Stage X11 plans endorsed.

Cheers,

David Grant | Vegetation Planning and Management Officer

City of Ballarat | PO Box 655, Ballarat, Victoria, 3353

P: (03) 5320 7457 | **M:** 0419 131 746 | <http://www.ballarat.vic.gov.au>

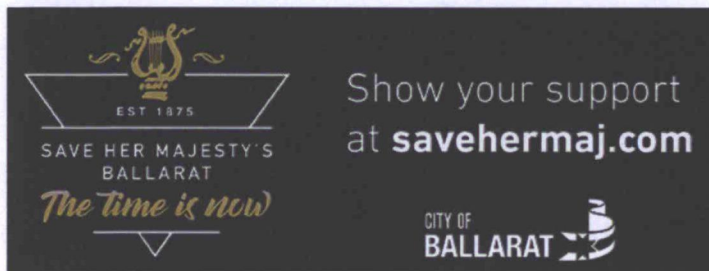

Join us on [Facebook](#) | [Twitter](#) | [Instagram](#) | [YouTube](#) | [Snapchat](#) | [Have Your Say](#)

The City of Ballarat respectfully acknowledges the Wadawurrung and Dja Dja Wurrung people - traditional custodians of the land on which we live and work.

Please consider the environment before printing this email.

From: Angela Day <angela@plotla.com.au>

Sent: Friday, 2 November 2018 5:34 PM

To: Info@Ballarat.vic.gov.au

Cc: David Grant <davidgrant@ballarat.vic.gov.au>; Natasha O'Brien <Natasha@integragroup.com.au>; Richard Howell <richard@plotla.com.au>

Subject: Landscape Plan for Approval - Stage X11, Lucas (PLP/2016/141)

To whom it may concern,

We refer to the above project and, on behalf of Integra Land Pty Ltd, are pleased to attach the **Landscape Plans (revision TP1) for approval** in accordance with conditions 3 – 6 of **planning permit PLP/2016/141**.

We have also attached the following documents to support this submission.

- The endorsed *Landscape Masterplan* in accordance with condition 2 of planning permit PLP/2016/141 and the *Precinct X Development Plan Version 11*.
- *LDM checklists* along with the maintenance schedule.

Should you have any queries or require further information, please do not hesitate to contact Richard Howell (0412 854 007) or myself at this office.

Kind regards,

Angela Day, Registered Landscape Architect AILA
M. 0428 327 304

PLOT Landscape Architects Pty Ltd

ACN 607 524 158 ABN 64 900 120 469

Important: This message is intended only for the use of the individual or entity named above and may contain information that is confidential and privileged. If you have received this e-mail in error, please notify the sender immediately and delete the message. Any representations or opinions expressed are those of the individual sender. **Limits of Liability and disclaimer:** PLOT Landscape Architects Pty Ltd is not liable for any loss, damage, claim, cost, demand or expense arising in connection with or without the use of data supplied in this e-mail transmission. Whilst virus scanning is utilised by PLOT Landscape Architects Pty Ltd, no responsibility is taken for any virus damage that may originate from this transmission. Before opening or using attachments check them for viruses and defects.